

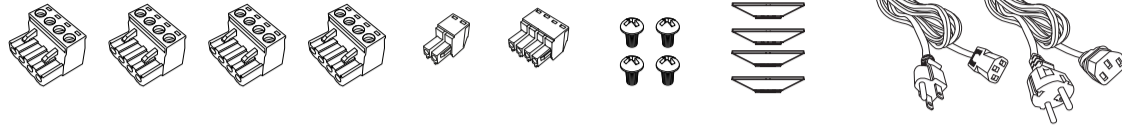

CI 8-150 DSP V2 Multi-Channel Amplifier

Quick Setup Guide

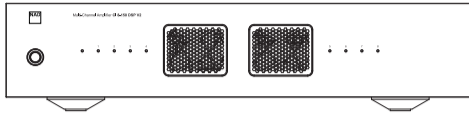

nadelectronics.com/product/CI-8-150-V2-multi-channel-amplifier
support.nadelectronics.com

GUIDELINE FOR NETWORK SETUP CONNECTION

This guideline is applicable to iOS/iPadOS and Android devices as well as Windows and macOS desktops. Adapt the guidelines according to your control device.

- 1 Use an Ethernet cable (not supplied) to connect CI 8-150 DSP V2's LAN port to your Wired network or router.

IMPORTANT NOTES

- For wired connection to be established, ensure that a broadband router that supports Ethernet is setup and available.
 - Ensure that CI 8-150 DSP V2 and the control device (Windows/macOS desktops and smartphone devices) are connected to the same network.
 - Use the information in the rear panel MAC (Media Access Control) address sticker to identify the CI 8-150 DSP V2 from your network.
- 2 Power up your CI 8-150 DSP V2. The CI 8-150 DSP V2 will not communicate with the network when in Eco standby mode.
 - 3 Use any network IP scanner to find your CI 8-150 DSP V2's Network ID, which is the product name followed by the last six digits of the MAC address (example: NAD CI 8-150 DSP V2_123456). The MAC address is listed on a sticker in the rear panel. Note also the corresponding IP address assigned by the network.
 - 4 Type the IP address into your control device's web browser to access the User Interface of your CI 8-150 DSP V2.
 - 5 Use the various menu options in the User Interface to configure your CI 8-150 DSP V2.

FIRMWARE UPDATE PROCEDURE

- 1 Once you access the User Interface of your CI 8-150 DSP V2, navigate to the **Setup** section. Under the **Information, Backup and Restore** tab, select **Check for Update** to verify if a firmware update is available.
- 2 Follow the firmware update prompt instructions to complete the upgrade process.

POWER MODE OPTIONS

SETTING	DESCRIPTION
Power button	Use the Power button to toggle the unit between operating and standby modes.
Always On	Unit is always in operating mode. Shut down power by unplugging the power cord from the mains power source.
12V Trigger	Unit will switch between operating and standby modes based on the presence or absence of a +12V DC supply from compatible devices connected to the rear panel +12V TRIGGER IN.
Signal Sense	Unit will instantaneously turn from standby to operating mode if it senses any input signal (approximately above 2 mV RMS input) applied through any of the GLOBAL or LINE INPUT sockets.

IMPORTANT

CI 8-150 DSP V2 factory default setting for Eco Mode is ON. When the settings for "Power Mode" is "Signal Sense" or "Power Button" and "Eco Mode" is "ON", the unit will automatically enter Eco standby mode after 20 minutes of no active audio source input.

1.

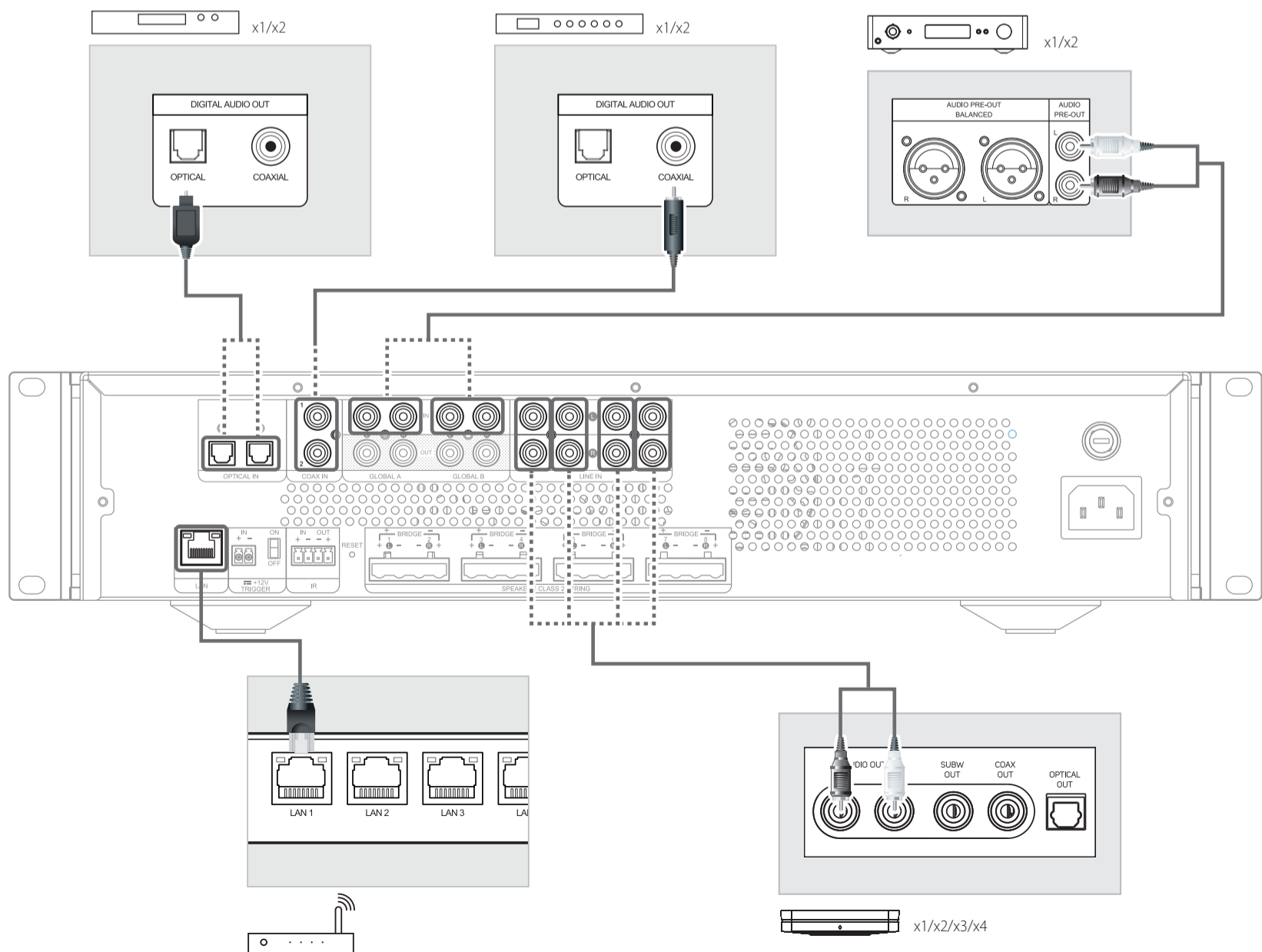

2.

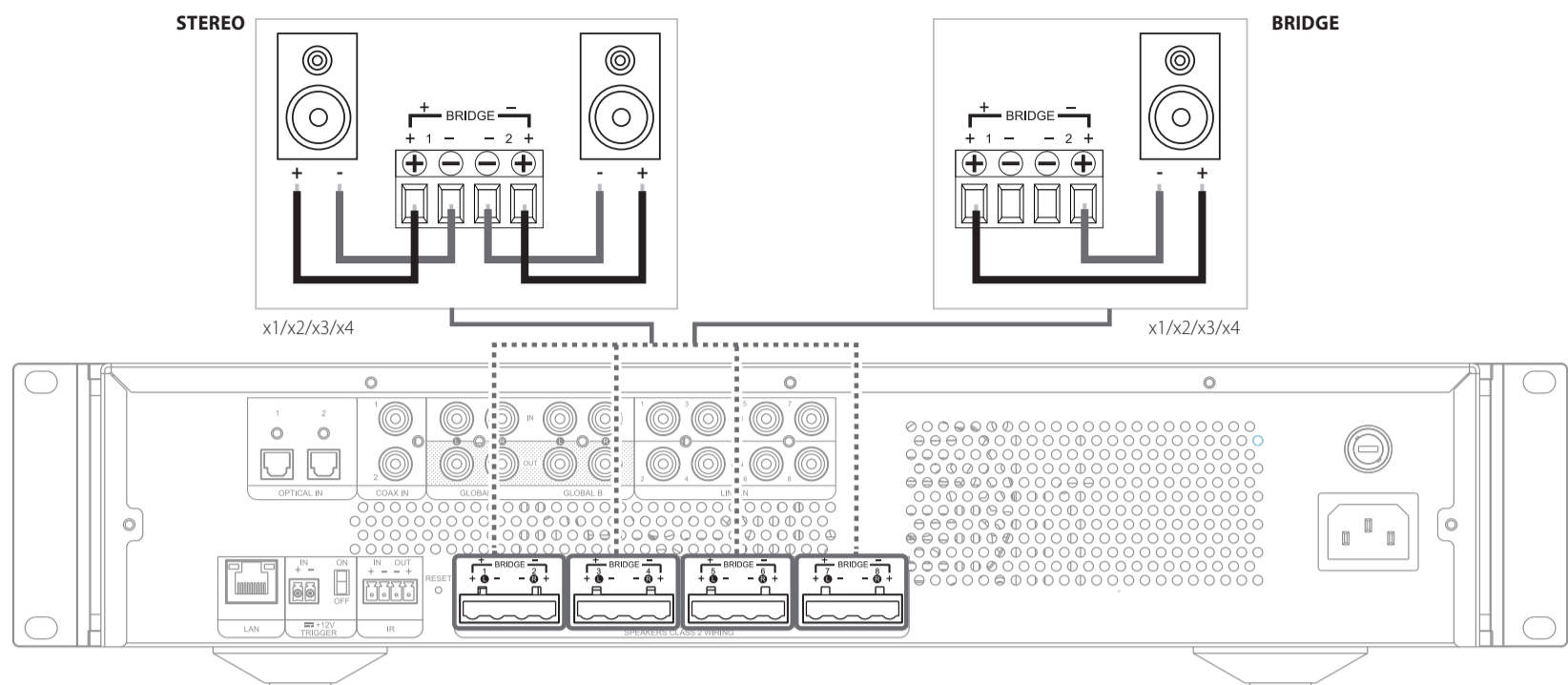

3.

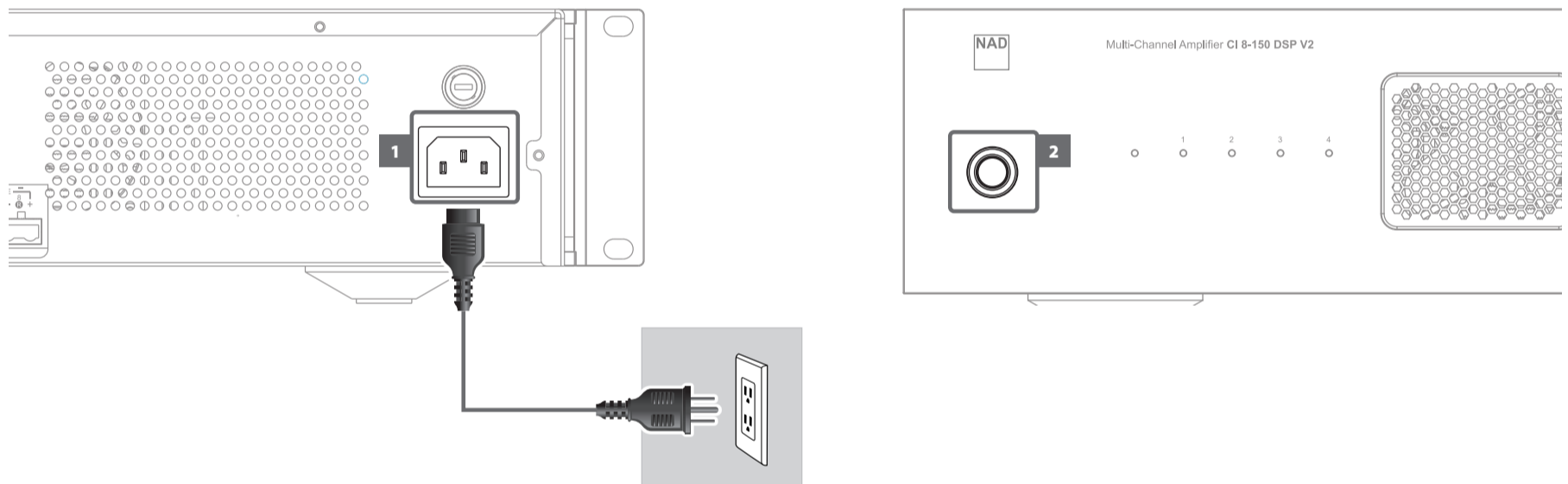

4.

STANDBY AND CHANNEL LED STATUS INDICATORS

DESCRIPTION	STANDBY LED STATUS	CHANNEL LED 1-8 STATUS
Operating mode	Blue	The corresponding channel LED is blue if there is an active source input signal. If there is no active source input signal, the corresponding channel LED is off or no light.
Standby mode	Amber	Off, no light
System reboot	Blue - Amber - Red - Blue	Blue - no light - blue or no light depending on the presence or absence of an active source input.
Overvoltage or under voltage	Red	Off, no light
AMP current error	Blue	Corresponding channel LED is red
AMP DC error	Red	Off, no light

HEAT OUTPUT (BTU)

CONDITION	INPUT POWER (W)	230V/50Hz		120V/60Hz			
		OUTPUT POWER TO SPEAKER (W)	HEAT OUTPUT (BTU/HR)	INPUT POWER (W)	OUTPUT POWER TO SPEAKER (W)	HEAT OUTPUT (BTU/HR)	
Eco mode Standby Power at 8 ohms	0.33	-	1.13	0.39	-	1.33	
Network Standby Power at 8 ohms	1.19	-	4.06	1.30	-	4.44	
Idle power at 8 ohms	86.00	-	-	87.00	-	-	
Output power at 8 ohms, all channels driven	1/8 rated power	241.00	150.00	310.50	245.00	150.00	324.15
	1/3 rated power	506.00	400.00	361.69	516.00	400.00	395.81
	1/2 rated power	735.00	600.00	460.64	760.00	600.00	545.94
	Full rated power	1376.00	1200.00	600.54	1453.00	1200.00	863.27
Output power at 4 ohms, all channels driven	1/8 rated power	248.00	150.00	334.39	252.00	150.00	348.04
	1/3 rated power	526.00	400.00	429.93	530.00	400.00	443.58
	1/2 rated power	761.00	600.00	549.49	786.00	600.00	634.66
	Full rated power	1443.00	1200.00	829.15	1510.00	1200.00	1057.78