

# 4K HDR 4:4:4 60Hz HDBaseT™ Extender with DSC Supporting USB.2.0 Client/host (4K: 100m/328ft)

**EX-100-H2-PRO**

**WyreStorm**

## Specification Sheet

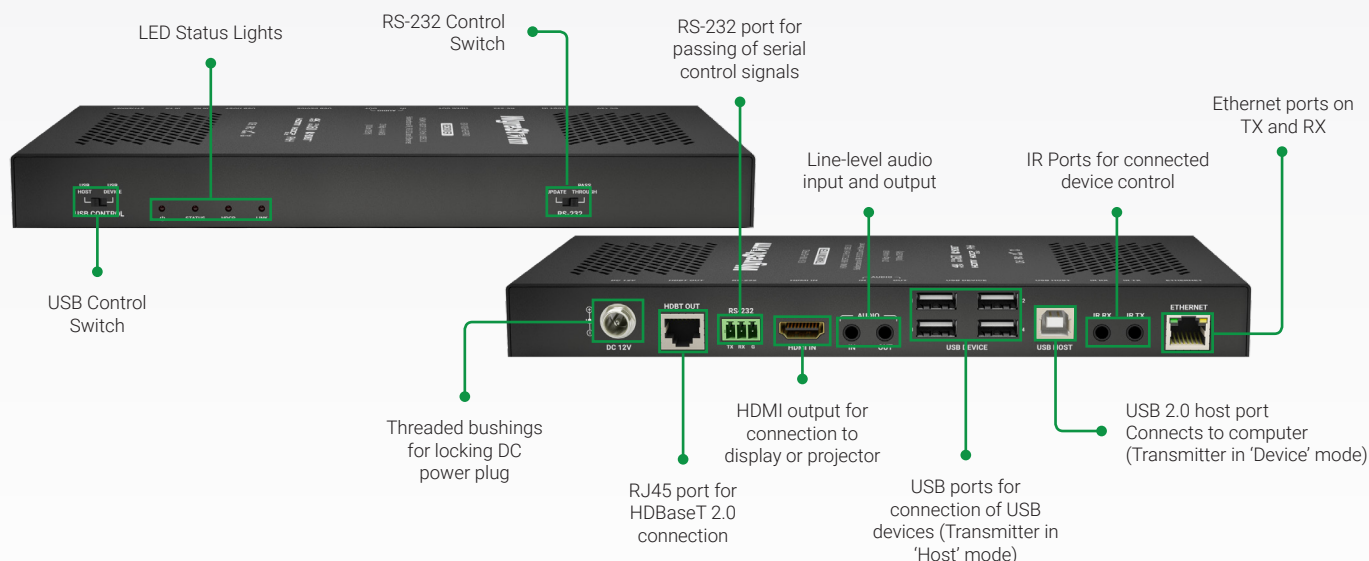

*WyreStorm - Powerful. Reliable. Simple.*

## Introduction

Utilizing the best in HDBaseT technology, the EX-100-H2-PRO uses the powerful 2.0 chipset for 5-Play functionality: 4K HDMI, USB, Ethernet, Control and Power over 100m/328ft of Cat 6 cable. Using DSC (display stream compression) the EX-100-H2-PRO can support HDMI video up to 2160p 4:4:4 at 60Hz (18Gbps) without any visual loss in quality or latency. With HD's and data transfer in mind, the EX-100-H2-PRO supports USB 2.0 devices at up to 480Mbps, catering for powerful webcams, smart whiteboards and flash drives alike. Also included is a dedicated 2-way audio lane for transmission of analog stereo audio signals from TX-RX and RX-TX.

## Key Features

- Point-to-point HDBaseT Extender supporting:
  - Content up to 4K/60 4:4:4 & RGB 8-bit
  - The latest HDR standards, including HDR-10, HLG and Dolby Vision at 30Hz
  - HDCP 2.2 encryption technology ensuring compatibility with the latest 4K UHD content and sources
  - HD Multichannel audio up to DTS:X and Dolby Atmos to all outputs
- Extends 2160p 4:4:4 or 4:2:2 12-bit HDR content from a source to a display or projector using HDBaseT up to 100m/328ft
- Automatically activated DSC lossless compression handles HDMI content up to 17.8Gbps
- HDMI Input and HDMI output supports bandwidths of up to 18Gbps
- Compatible with DVI-I and DP++ v1.3 signals from compatible devices
- Bidirectional USB 2.0 passthrough offering 480Mbps transfer and HID extension, with host and 4 device ports on both TX and RX
- 10/100 Ethernet port on both ends for extension of LAN to TX or RX
- Bidirectional audio lane separate to HDMI signal sends and receives analog audio signals at either end
- Bidirectional IR, RS-232 and CEC communication
- DIP Switch selection for direction of USB control, long cable mode and firmware update
- Backwards compatible with HDBaseT™ 1.0 transmission and receiving devices (lowest denominator takes priority)
- LED indication for power supply to units, signal status to show established display connection, HDCP presence in signal and transmission link
- 2-way PoH (Power over HDBaseT™) enables either transmitter or receiver to be remotely powered by the other unit
- Locking DC power jacks
- 12v DC PSU with US, UK, EU & AU Power cables included
- Mounting brackets included

## In the Box

1x EX-100-H2-PRO Transmitter (TX)  
1x EX-100-H2-PRO Receiver (RX)  
1x IR Emitter  
1x IR Receiver

2x 3-pin Terminal Block  
4x Mounting Brackets  
1x Quickstart Guide  
1x 12V DC 3A Power Supply (US/UK/EU/AU)

# Specifications

Audio and Video				
	Transmitter		Receiver	
Inputs	1x HDMI In: 19-pin type A 1x Audio In: 3.5mm (1/8in) TRS Stereo		1x HDBT In: 8-pin RJ-45 Female 1x Audio In: 3.5mm (1/8in) TRS Stereo	
Outputs	1x HDBT Out: 8-pin RJ-45 Female 1x Audio Out: 3.5mm (1/8in) TRS Stereo		1x HDMI Out: 19-pin type A 1x Audio Out: 3.5mm (1/8in) TRS Stereo	
Output Video Encoding	HDBaseT Class C			
Encoding Data Rate	10.2Gbps			
End to End Latency	10μs (micro seconds)			
Audio Formats	2ch Analog/PCM   Multichannel: LPCM up to DTS-X and Dolby Atmos			
Video Resolutions (Max)	Video Resolution	HDMI	Cat6	Cat6a/7
	1920x1080p @120Hz 12bit	70m/230ft	70m/230ft	100m/328ft
	1920x1080p @60Hz 12bit	15m/49ft	100m/328ft	100m/328ft
	3840x2160p @24Hz 10bit 4:2:0 HDR	15m/49ft	100m/328ft	100m/328ft
	3840x2160p @60Hz 8bit 4:4:4	7m/23ft	70m/230ft	100m/328ft
	3840x2160p @60Hz 10bit 4:2:0 HDR	5m/16ft	70m/230ft	100m/328ft
	3840x2160p @60Hz 12bit 4:2:2 HDR	5m/16ft	70m/230ft	100m/328ft
	Note: WyreStorm recommends the use of shielded category cable to minimize signal noise and interference.			
Supported Standards	DCI   RGB   HDR   HDR10   Dolby Vision up to 30Hz   HLG   BT.2020   BT.2100			
Maximum Pixel Clock	HDMI: 600MHz   HDBaseT: 340MHz			
Communication and Control				
HDMI	HDMI   HDCP 2.2   EDID     CEC Pass-through   DVI/D supported with adapter (not included)   DP++			
HDBaseT	HDMI   HDCP 2.2   EDID   Audio   2-way PoH   Bidirectional IR/RS-232/Ethernet   CEC			
Ethernet	1x Ethernet: 8-pin RJ-45 Female   Bidirectional over HDBaseT			
IR	1x IR RX: 3.5mm (1/8in) TRS Stereo   1x IR TX: 3.5mm (1/8in) TS Mono (Transmitter and Receiver)			
RS-232	1x RS-232: 3-pin Phoenix (Transmitter and Receiver)			
USB	1x Type B (host)   4x Type A (device) (Transmitter and Receiver) USB direction must be set using switch on both transmitter and receiver USB hub compatible   Maximum: 7 devices, 23 endpoints Maximum uplink speed: 190Mbps			
Power				
Power Supply	12V DC 3A			
Max Power Consumption	8.88W			
Environmental				
Operating Temperature	32°F ~ 113°F (0°C ~ 45°C)   10% ~ 90%, non-condensing			
Storage Temperature	-4°F to ~ 158°F (-20°C ~ +70°C)   10% ~ 90%, non-condensing			
Maximum BTU	30.30 BTU/hr			
Dimensions and Weight				
Rack Units   Wall Box	<1U			
Height With   Without Feet	21mm/0.83in			
Width With   Without Brackets	195mm/7.68in			
Depth With   Without Handles	94.8mm/3.74in			
Weight	0.36kg/0.79lbs			
Regulatory				
Safety and Emission	CE   FCC   RoHS   RCM			

# Right Product for the Right Application.

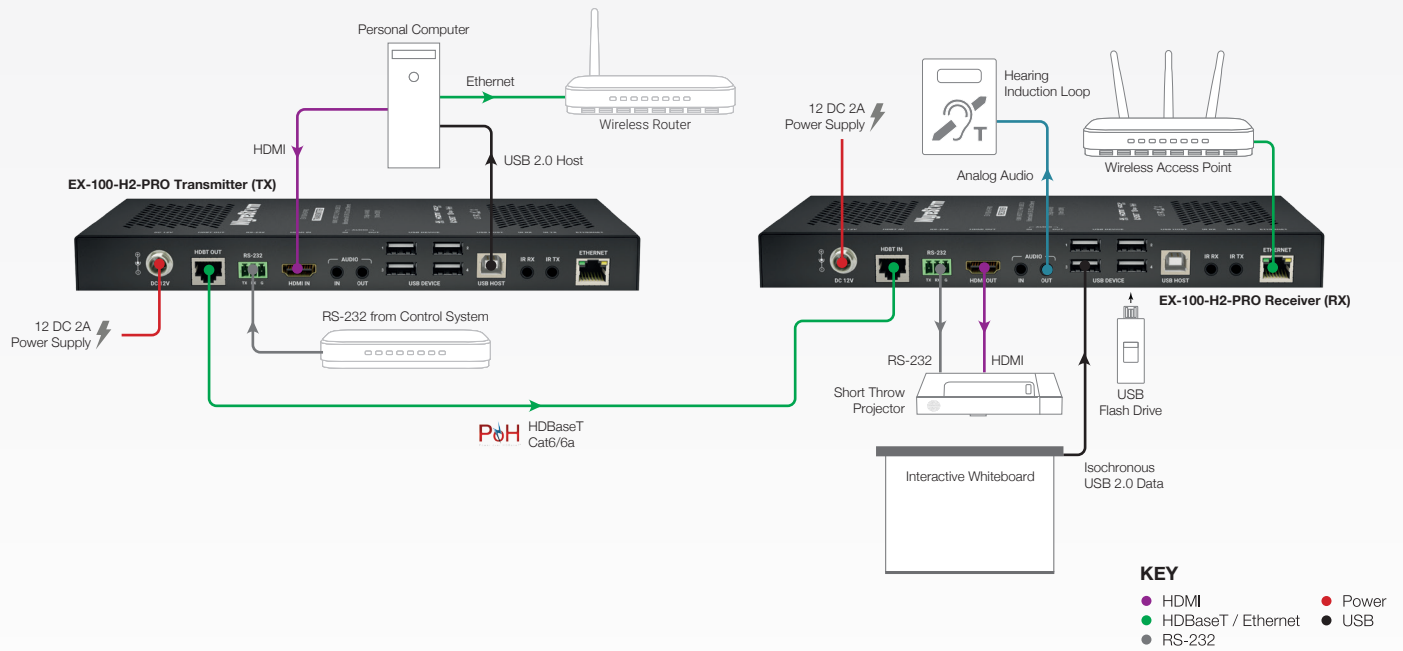

**Note:** WyreStorm reserves the right to change product specification, appearance or dimensions of this product at any time without prior notice.